











## HBGQ – HBS1 19mm SERIES mounting hole : $\Phi$ 19

### Order Code - Configurazione di un modello

Configura un pulsante o un interruttore impiegando la seguente simbologia :

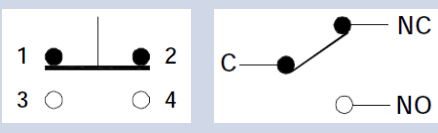
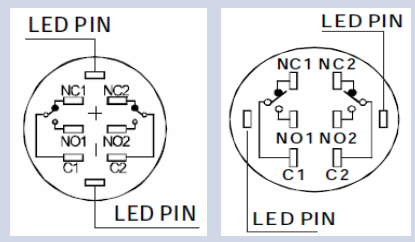
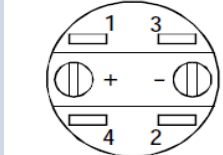
						
Fronte Front Shape	Contatti Contact configuration	Led Lamp Type	Contatti Oper. Type	Colore Led color	Volt Led Led volt.	Materiale Material
<b>F</b> : flat round <b>H</b> : H round <b>C</b> : concave <b>G</b> : H concave	<b>11</b> : 1NO 1NC <b>22</b> : 2NO 2NC <b>S</b> : screw terminal <b>J</b> : solder terminal  Action of selector and Key - lock button Azione del selettore 1 Keep 3 Full- momentary	<b>D</b> : dot led <b>E</b> : ring led  Operation position of selector and key - lock button : Posizione del selettore 2 Position 2 3 Position 3	<b>Z</b> : latching <b>X</b> : selector <b>Y</b> : key-lock <b>M</b> : buzzer <b>SM</b> : flash buz. <b>No letter</b> : <b>Push button</b> <b>Pulsante</b>	<b>R</b> Red <b>G</b> Green <b>Y</b> Yellow <b>O</b> Orange <b>B</b> Blue <b>W</b> White	<b>6</b> <b>12</b> <b>24</b> <b>36</b> <b>110</b> <b>190</b>	<b>N</b> = Nickel plated brass <b>S</b> = Stainless S. <b>A</b> = Zn-Al Alloy

Description - Descrizione	Figura	
Diagramm each single contact Schema elettrico ( singolo contatto )		
Symbol Simbolo		
<b>Nota :</b> Diagramm is referred for one single contact Riferito ad ogni singolo contatto	Can be configured two sets of switches: C1 and C2 ( C1 = 11 1NCNO C2 = 22 2NONC ) . +/- pins are led terminals Possono essere configurati due serie di contatti, C1 singolo e C2 doppio : ( C1 = 11 1NONC C2 = 22 2NONC ) I terminali +/- appartengono al diodo led.	 1, 2 for NC 3, 4 for NO +, - for LED

LampType	LED lamp(AC/DC)			Lamp Circuit Diagram
LEDColor				
Life	40000hours(Reference)			
RatedVoltage	AC/DC6V	AC/DC12V	AC/DC110V	
	AC/DC24V	AC/DC36V	AC/DC220V	
RatedCurrent	About15mA		About3mA	
Dropping Way	Innerresistance	Outerresistance when using6Vlamp		



Using AC/DC led lamp. Terminals have no difference of anode and cathode.  
 Non c'è differenza di polarità ai terminali del led. Collegando una resistenza esterna si può adattare il funzionamento del led ad una tensione superiore : ad esempio il led interno è di 5V. Con una resistenza esterna da 1K il led può funzionare a 12V.

HBGQ19 19mm Series mounting hole :  $\Phi$  19

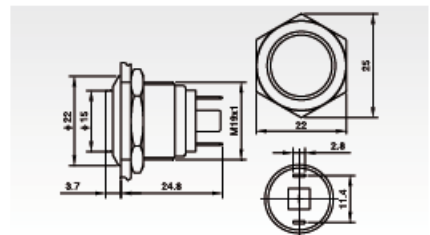
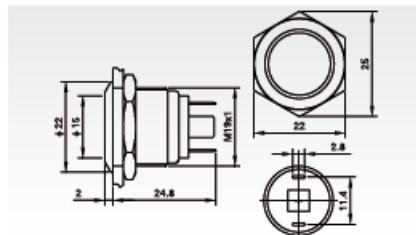
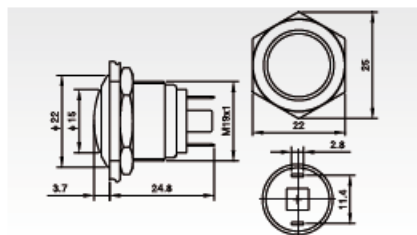
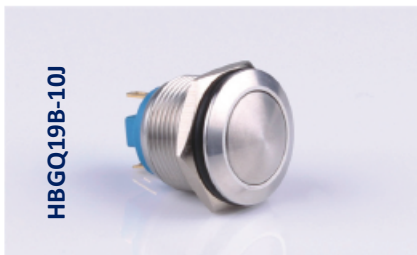
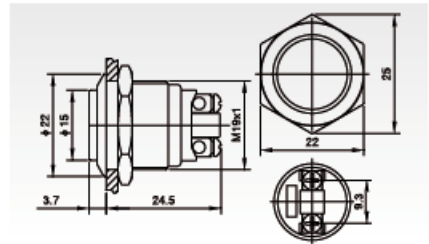
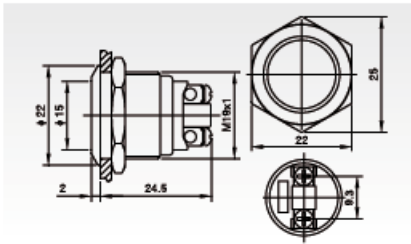
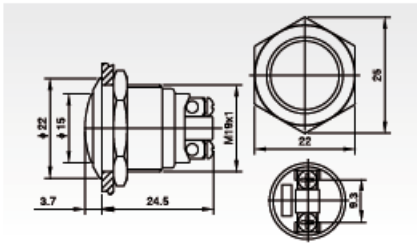

## HBGQ19B SERIES mounting hole : $\Phi$ 19



- Mounting hole size : 19mm
- Switch rating : 2A 36Vdc
- Contact configuration : 1 x NO
- Operation type : Momentary
- The crust material : Stainless steel
- Protection degree : IP65 IK09
- Domed

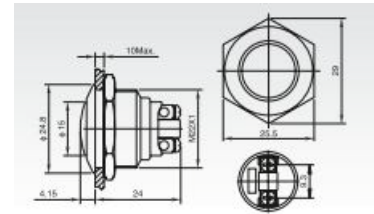

- Mounting hole size : 19mm
- Switch rating : 2A 36Vdc
- Contact configuration : 1 x NO
- Operation type : Momentary
- The crust material : Stainless steel
- Protection degree : IP65 IK09
- Flat round

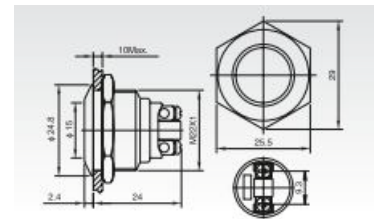

	HBGQ19B-10S	HBGQ19F-10S
Terminal Type	Screw terminal	Screw terminal
Switch type	X : Two terminal breakpoints slow moving contact	
Switch specifications	2A 36Vdc	2A 36Vdc
Contact Resistance (m $\Omega$ )	$\leq 50$	$\leq 50$
Insulation Resistance (M $\Omega$ )	$\geq 1000$	$\geq 1000$
Dielectric Strength (VAC)	2000	2000
Operating Temperature	-20°C ~ +55°C	-20°C ~ +55°C
Mechanical Life (times)	> 1.000.000	> 1.000.000
Electrical Life (times)	> 200.000	> 200.000
Panel Thickness (mm)	1 ~ 10	1 ~ 10
Torque (Nm)	5 ~ 14	5 ~ 14
Operating Pressure (N)	about 4	about 4
Operating Stroke (mm)	about 1,8	about 1,8
Protection Degree	IP65, IK09	IP65, IK09
Contact	Silver Alloy	Silver Alloy
Button	Stainless steel Mirror – Spiral pattern	
Case	Stainless steel – Nickel plated brass	
Base	PBT	PBT

Material

## HBGQ19B SERIES mounting hole : $\Phi$ 19

HBGQ19H-10



- Mounting hole size : 19mm
- Switch rating : 2A 36Vdc
- Contact configuration : 1 x NO
- Operation type : Momentary
- The crust material : Stainless steel
- Protection degree : IP65 IK09
- High round

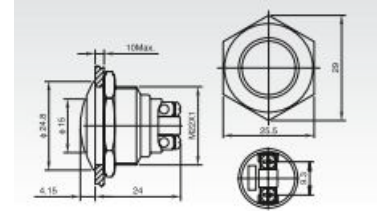

	HBGQ19H-10S	
Terminal Type	Screw terminal	
Switch type	X : Two terminal breakpoints slow moving contact	
Switch specifications	2A 36Vdc	
Contact Resistance (m $\Omega$ )	$\leq 50$	
Insulation Resistance (M $\Omega$ )	$\geq 1000$	
Dielectric Strength (VAC)	2000	
Operating Temperature	-20°C ~ +55°C	
Mechanical Life (times)	> 1.000.000	
Electrical Life (times)	> 200.000	
Panel Thickness (mm)	1 ~ 10	
Torque (Nm)	5 ~ 14	
Operating Pressure (N)	about 4	
Operating Stroke (mm)	about 1,8	
Protection Degree	IP65, IK09	
Contact	Silver Alloy	<b>Material</b>
Button	Stainless steel Mirror – Spiral pattern	
Case	Stainless steel – Nickel plated brass	
Base	PBT	

HBGQ19J SERIES mounting hole :  $\Phi$  19



HBGQ19B-10J

- Mounting hole size : 19mm
- Switch rating : 2A 36Vdc
- Contact configuration : 1 x NO
- Operation type : Momentary
- The crust material : Stainless steel
- Protection degree : IP65 IK09
- Domed

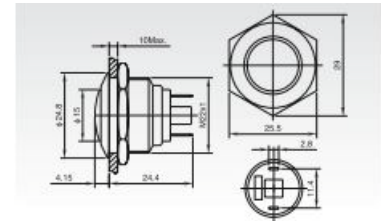

HBGQ19F-10J

- Mounting hole size : 19mm
- Switch rating : 2A 36Vdc
- Contact configuration : 1 x NO
- Operation type : Momentary
- The crust material : Stainless steel
- Protection degree : IP65 IK09
- Flat round

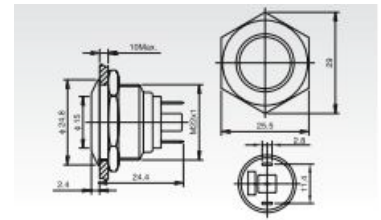

	HBGQ19B-10J	HBGQ19F-10J
Terminal Type	Pin terminal 2,8 x 0,5mm	Pin terminal 2,8 x 0,5mm
Switch type	X : Two terminal breakpoints slow moving contact	
Switch specifications	2A 36Vdc	2A 36Vdc
Contact Resistance (m $\Omega$ )	$\leq$ 50	$\leq$ 50
Insulation Resistance (M $\Omega$ )	$\geq$ 1000	$\geq$ 1000
Dielectric Strength (VAC)	2000	2000
Operating Temperature	-20°C ~ +55°C	-20°C ~ +55°C
Mechanical Life (times)	> 1.000.000	> 1.000.000
Electrical Life (times)	> 200.000	> 200.000
Panel Thickness (mm)	1 ~ 10	1 ~ 10
Torque (Nm)	5 ~ 14	5 ~ 14
Operating Pressure (N)	about 4	about 4
Operating Stroke (mm)	about 1,8	about 1,8
Protection Degree	IP65, IK09	IP65, IK09
Contact	Silver Alloy	Silver Alloy
Button	Stainless steel Mirror – Spiral pattern	
Case	Stainless steel – Nickel plated brass	
Base	PBT	PBT

**Material**

## HBGQ19J SERIES mounting hole : $\Phi$ 19

HBGQ19H-10J



- Mounting hole size : 19mm
- Switch rating : 2A 36Vdc
- Contact configuration : 1 x NO
- Operation type : Momentary
- The crust material : Stainless steel
- Protection degree : IP65 IK09
- High round

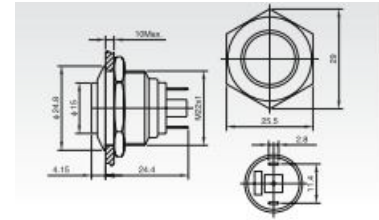

	HBGQ19H-10J	
Terminal Type	Pin terminal 2,8 x 0,5 mm	
Switch type	X : Two terminal breakpoints slow moving contact	
Switch specifications	2A 36Vdc	
Contact Resistance (m $\Omega$ )	$\leq 50$	
Insulation Resistance (M $\Omega$ )	$\geq 1000$	
Dielectric Strength (VAC)	2000	
Operating Temperature	-20°C ~ +55°C	
Mechanical Life (times)	> 1.000.000	
Electrical Life (times)	> 200.000	
Panel Thickness (mm)	1 ~ 10	
Torque (Nm)	5 ~ 14	
Operating Pressure (N)	about 4	
Operating Stroke (mm)	about 1,8	
Protection Degree	IP65, IK09	
Contact	Silver Alloy	<b>Material</b>
Button	Stainless steel Mirror – Spiral pattern	
Case	Stainless steel – Nickel plated brass	
Base	PBT	



HBGQ19F-10E SERIES mounting hole :  $\Phi$  19



- Mounting hole size : 19mm
- Switch rating : 2A 36V
- Contact configuration : 1 NO
- Operation type : Momentary
- The crust material : Stainless steel
- Protection degree : IP65 IK08
- Flat round Ring illuminated

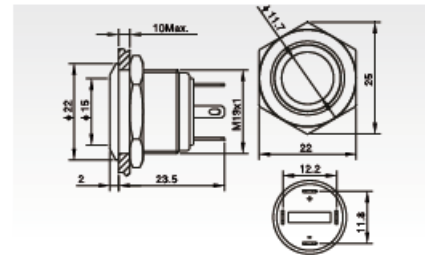

- Mounting hole size : 19mm
- Switch rating : 2A 36V
- Contact configuration : 1 NO
- Operation type : Momentary
- The crust material : Stainless steel
- Protection degree : IP65 IK08
- Flat Ring illuminated

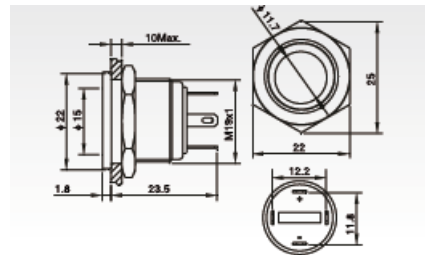

	HBGQ19F10EJS	HBGQ19FP10EJS
Terminal Type	Pin Terminal (2.8 x 0.5mm)	Pin Terminal (2.8 x 0.5mm)
Switch type	C : Single breackpoint snap-action chngover contacts	ZA : Double break fast motion chngover contact
Switch specifications	Ith: 2A / Ui: 36VDC	Ith: 2 / 36VDC
Contact Resistance (mΩ)	≤ 50	≤ 50
Insulation Resistance (MΩ)	≥ 1000	≥ 1000
Dielectric Strength (VAC)	2000	2000
Operating Temperature	-20°C ~ +55°C	-20°C ~ +55°C
Mechanical Life (times)	> 1.000.000	> 1.000.000
Electrical Life (times)	> 50.000	> 50.000
Panel Thickness (mm)	1 ~ 10	1 ~ 6
Torque (Nm)	5 ~ 14	5 ~ 14
Operating Pressure (N)	about 3 ~ 5	about 5,5
Operating Stroke (mm)	about 3,1	about 2,5
Protection Degree	IP67, IK09	IP65, IK10
Contact	Silver Alloy	Silver Alloy
Button	Stainless Steel	Stainless Steel
Case	Stainless Steel	Stainless Steel
Base	PBT	PA
Type	Dot illuminated LED	Ring illuminated
Rated Voltage (Vac-dc)	6/12/24/110/220	6/12/24/110/220
Color	R G Y O B W	R G Y O B W
Life	50000 hours	









Material

Lamp

## HBGQ – HBS1 19mm SERIES mounting hole : $\Phi$ 19

### Order Code - Configurazione di un modello

Configura un pulsante o un interruttore impiegando la seguente simbologia :

						
Fronte Front Shape	Contatti Contact configuration	Led Lamp Type	Contatti Oper. Type	Colore Led color	Volt Led Led volt.	Materiale Material
<b>F</b> : flat round <b>H</b> : H round <b>C</b> : concave <b>G</b> : H concave	<b>11</b> : 1NO 1NC <b>22</b> : 2NO 2NC <b>S</b> : screw terminal <b>J</b> : solder terminal  Action of selector and Key - lock button Azione del selettore 1 Keep 3 Full- momentary	<b>D</b> : dot led <b>E</b> : ring led  Operation position of selector and key - lock button : Posizione del selettore 2 Position 2 3 Position 3	<b>Z</b> : latching <b>X</b> : selector <b>Y</b> : key-lock <b>M</b> : buzzer <b>SM</b> : flash buz. <b>No letter</b> : <b>Push button</b> <b>Pulsante</b>	<b>R</b> Red <b>G</b> Green <b>Y</b> Yellow <b>O</b> Orange <b>B</b> Blue <b>W</b> White	<b>6</b> <b>12</b> <b>24</b> <b>36</b> <b>110</b> <b>190</b>	<b>N</b> = Nickel plated brass <b>S</b> = Stainless S. <b>A</b> = Zn-Al Alloy

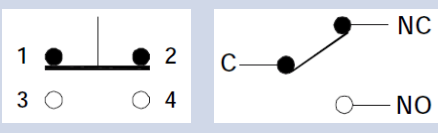
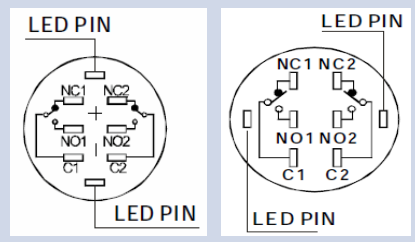
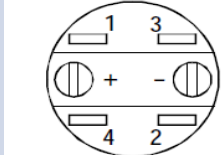
Description - Descrizione	Figura	
Diagramm each single contact Schema elettrico ( singolo contatto )		
Symbol Simbolo		
<b>Nota :</b> Diagramm is referred for one single contact Riferito ad ogni singolo contatto	Can be configured two sets of switches: C1 and C2 ( C1 = 11 1NCNO C2 = 22 2NONC ) . +/- pins are led terminals Possono essere configurati due serie di contatti, C1 singolo e C2 doppio : ( C1 = 11 1NONC C2 = 22 2NONC ) I terminali +/- appartengono al diodo led.	 1, 2 for NC 3, 4 for NO +, - for LED

LampType	LED lamp(AC/DC)			Lamp Circuit Diagram
LEDColor				
Life	40000hours(Reference)			
RatedVoltage	AC/DC6V	AC/DC12V	AC/DC110V	
	AC/DC24V	AC/DC36V	AC/DC220V	
RatedCurrent	About15mA		About3mA	
Dropping Way	Innerresistance	Outerresistance when using6Vlamp		



Using AC/DC led lamp. Terminals have no difference of anode and cathode.  
 Non c'è differenza di polarità ai terminali del led. Collegando una resistenza esterna si può adattare il funzionamento del led ad una tensione superiore : ad esempio il led interno è di 5V. Con una resistenza esterna da 1K il led può funzionare a 12V.



HBGQ – HBS1 19mm SERIES

mounting hole :  $\Phi$  19

HBS1AGQ-S



HBS1AGQ-EM



HBS1AGQ-DS



HBS1AGQ-ES



HBS1AGQ-X



HBS1AGQ-Y



HBS1AGQH-ES



HBS1AGQ-S



VISTA

HBGQ19 SERIES mounting hole :  $\Phi$  19



HBS1AGQH-ES



HBS1AGQ-S

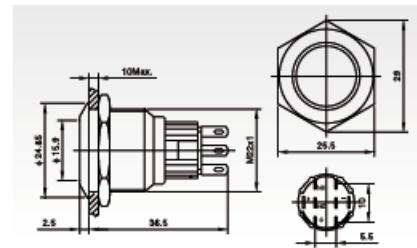
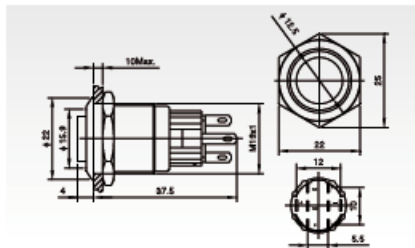

■ = contatti ▲ = colore ▲ = V Led

■ ▲ ▲		HBS1AGQH-ES	HBS1AGQ-S
Terminal Type		Pin Terminal (2.8 x 0.5mm)	Pin Terminal (2.8 x 0.5mm)
Switch Type		Momentary or Latching	
Switch Specifications		Ith: 5A / Ui: 250VAC	Ith: 5A / Ui: 250VAC
Contact Resistance (mΩ)		≤ 50	≤ 50
Insulation Resistance (MΩ)		≥ 1000	≥ 1000
Dielectric Strength (VAC)		2000	2000
Operating Temperature		-20°C ~ +55°C	-20°C ~ +55°C
Mechanical Life (times)		> 1.000.000	> 1.000.000
Electrical Life (times)		> 50.000	> 50.000
Panel Thickness (mm)		1 ~ 10	1 ~ 10
Tonque (Nm)		5 ~ 14	5 ~ 14
Operating Pressure (N)		3 ~ 5	3 ~ 5
Operating Stroke (mm)		about 3.1	about 3.1
Protection Degree		IP67, IK09	IP67, IK09
Material	Contact	Silver Alloy	Silver Alloy
	Button	Stainless Steel	Stainless Steel
	Case	Stainless Steel	Stainless Steel
	Base	PBT	PBT
Lamp Parameters	Type	Dot-illuminated LED	Ring-illuminated LED
	Rated Voltage (V)	6 / 12 / 24 / 110 / 220	6 / 12 / 24 / 110 / 220
	Color	R G Y O B W	R G Y O B W
	Life	50.000	50.000

HBS1GQ19 SERIES mounting hole :  $\Phi$  19

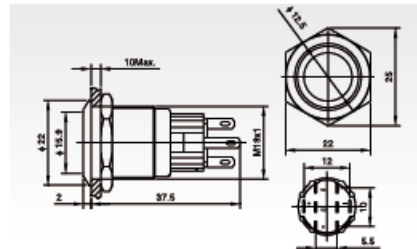
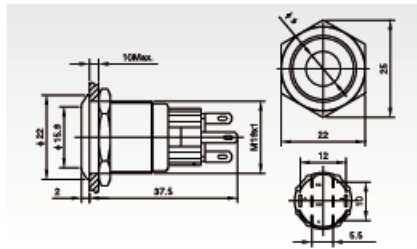

■ = contatti ▲ = colore ▲ = V Led

■ ▲ ▲		HBS1AGQ-DS	HBS1AGQ-ES
Terminal Type		Pin Terminal (2.8 x 0.5mm)	Pin Terminal (2.8 x 0.5mm)
Switch Type		Momentary or Latching	
Switch Specifications		Ith: 5A / Ui: 250VAC	Ith: 5A / Ui: 250VAC
Contact Resistance (mΩ)		≤ 50	≤ 50
Insulation Resistance (MΩ)		≥ 1000	≥ 1000
Dielectric Strength (VAC)		2000	2000
Operating Temperature		-20°C ~ +55°C	-20°C ~ +55°C
Mechanical Life (times)		> 1.000.000	> 1.000.000
Electrical Life (times)		> 50.000	> 50.000
Panel Thickness (mm)		1 ~ 10	1 ~ 10
Tonque (Nm)		5 ~ 14	5 ~ 14
Operating Pressure (N)		3 ~ 5	3 ~ 5
Operating Stroke (mm)		about 3.1	about 3.1
Protection Degree		IP67, IK09	IP67, IK09
Material	Contact	Silver Alloy	Silver Alloy
	Button	Stainless Steel	Stainless Steel
	Case	Stainless Steel	Stainless Steel
	Base	PBT	PBT
Lamp Parameters	Type	Dot-illuminated LED	Ring-illuminated LED
	Rated Voltage (V)	6 / 12 / 24 / 110 / 220	6 / 12 / 24 / 110 / 220
	Color	R G Y O B W	R G Y O B W
	Life	50.000	50.000

HBS1AGQ19 SERIES mounting hole :  $\Phi$  19

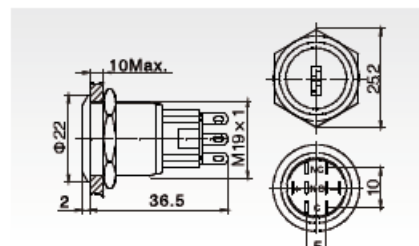
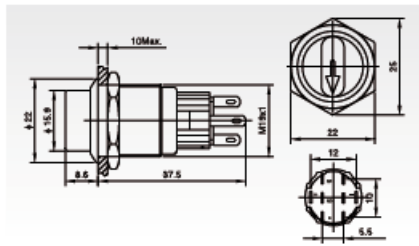

■ = contatti ▲ = colore ▲ = V Led ◆● = Key Lock Selector

■▲▲◆●		HBS1AGQ-X	HBS1AGQ-Y
Terminal Type		Pin Terminal (2.8 x 0.5 mm)	Pin Terminal (2.8 x 0.5 mm)
Switch Type		X= Selector Switch Y= Ley-Lock button M= Buzzer	
Switch Specifications		Ith: 5A / Ui: 250VAC	Ith: 5A / Ui: 250VAC
Contact Resistance (mΩ)		≤ 50	≤ 50
Insulation Resistance (MΩ)		≥ 1000	≥ 1000
Dielectric Strength (VAC)		2000	2000
Operating Temperature		-20°C ~ +55°C	-20°C ~ +55°C
Mechanical Life (times)		> 500.000	> 500.000
Electrical Life (times)		> 50.000	> 50.000
Panel Thickness (mm)		1 ~ 10	1 ~ 10
Tonque (Nm)		5 ~ 14	5 ~ 14
Protection Degree		IP65	-
Material	Contact	Silver Alloy	Silver Alloy
	Button	Stainless Steel	Stainless Steel
	Case	Stainless Steel	Stainless Steel
	Base	PBT	PBT
Lamp Parameters	Type	Arrow LED / Pfeil LED	-
	Rated Voltage (V)	1.8 / 2.8 / 6 / 12 / 24 / 110 / 220	-
	Color	<b>R</b> <b>G</b> <b>Y</b> <b>O</b> <b>B</b> <b>W</b>	-
	Life	50.000	-

HBS1AGQ19 SERIES mounting hole :  $\Phi$  19

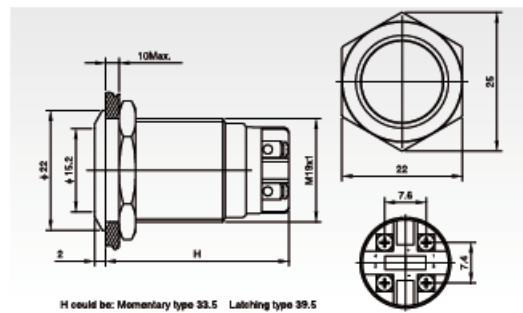
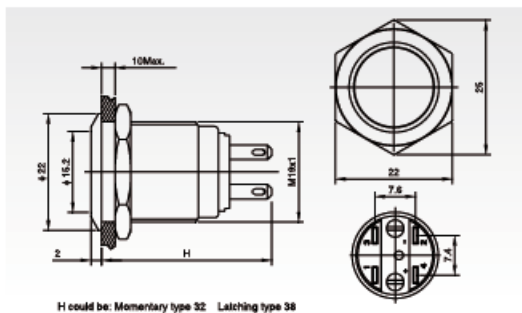



■ = contatti ▲ = colore ▲ = V Led ◆● = Key Lock - Selector - Buzzer





■ ▲ ▲ ◆		HBS1AGQ-S	HBS1AGQ-EM
Terminal Type		Pin Terminal (2.8 x 0.5mm)	Pin Terminal (2.8 x 0.5mm)
Switch Type			- M= Buzzer
Switch Specifications		Ith: 5A / Ui: 250VAC	-
Contact Resistance (mΩ)		≤ 50	-
Insulation Resistance (MΩ)		≥ 1000	-
Dielectric Strength (VAC)		2000	2000
Operating Temperature		-20°C ~ +55°C	-20°C ~ +55°C
Mechanical Life (times)		> 1.000.000	-
Electrical Life (times)		> 50.000	-
Panel Thickness (mm)		1 ~ 10	1 ~ 10
Tonque (Nm)		5 ~ 14	5 ~ 14
Operating Pressure (N)		about 4	-
Operating Stroke (mm)		about 2.5	-
Protection Degree		IP67, IK09	IP50, IK04
Material	Contact	Silver Alloy	-
	Button	Stainless Steel	Stainless Steel
	Case	Stainless Steel	Stainless Steel
	Base	PBT	PBT
Lamp Parameters	Type	-	Buzzer / Buzzer with illumination
	Rated Voltage (V)	-	12 / 24
	Color	<a href="http://www.parsicitalia.it">www.parsicitalia.it</a>	<b>R G Y O B W</b>
	Sound Intensity (dB)	<a href="mailto:info@parsicitalia.com">info@parsicitalia.com</a>	≥ 85 (1m)

## HBS1GQ 19mm Series mounting hole : $\Phi 19$

### Order Code - Configurazione di un modello

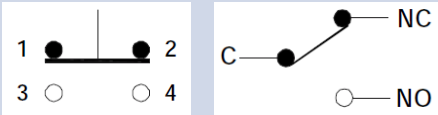
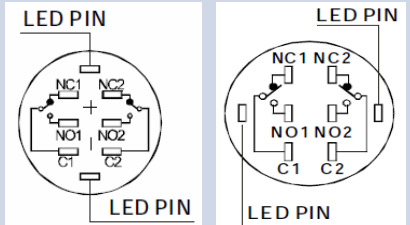
Configura un pulsante o un interruttore impiegando la seguente simbologia :

★	■	◆	■	▲	▲	●
Fronte Front Shape	Contatti Contact configuration	Led Lamp Type	Contatti Oper. Type	Colore Led color	Volt Led Led volt.	Materiale Material
<b>F : flat round</b> <b>H : H round</b> <b>C : concave</b> <b>G : H concave</b>	<b>11 : 1NO 1NC</b> <b>22 : 2NO 2NC</b> <b>S : screw terminal</b> <b>J : solder terminal</b>  Action of selector and Key - lock button Azione del selettore  <b>1 Keep</b> <b>3 Full- momentary</b>	<b>D : dot led</b> <b>E : ring led</b>  Operation position of selector and key - lock button : Posizione del selettore <b>2 Position 2</b> <b>3 Position 3</b>	<b>Z : latching</b> <b>X : selector</b> <b>Y : key-lock</b> <b>M : buzzer</b> <b>SM : flash buz.</b> <b>No letter :            Push button            Pulsante</b>	<b>R Red</b> <b>G Green</b> <b>Y Yellow</b> <b>O Orange</b> <b>B Blue</b> <b>W White</b>	<b>6</b> <b>12</b> <b>24</b> <b>36</b> <b>110</b> <b>190</b>	<b>N = Nickel            plated brass</b>  <b>S = Stainless            S.</b> <b>A = Zn-Al            Alloy</b>

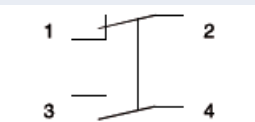
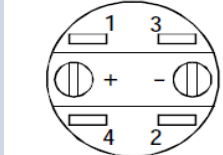
Description - Descrizione	Figura	
Diagramm each single contact Schema elettrico ( singolo contatto )		
 = contatti  = colore  = V Led		
<b>Per ogni ordine specificare sempre il numero dei contatti, il colore led, la tensione di lavoro led</b>	<p>Can be configured two sets of switches: C1 and C2 ( C1 = 11 1NCNO C2 = 22 2NONC ) .            +/- pins are led terminals            Possono essere configurati due serie di contatti, C1 singolo e C2 doppio :            ( C1 = 11 1NONC C2 = 22 2NONC )            I terminali +/- appartengono al diodo led.</p>	<p>1, 2 for NC            3, 4 for NO            +, - for LED</p>
<b>Nota :</b> Diagramm is referred for one single contact Riferito ad ogni singolo contatto		

LampType	LED lamp(AC/DC)			Lamp Circuit Diagram
LEDColor				
Life	40000hours(Reference)			
RatedVoltage	AC/DC6V	AC/DC12V	AC/DC110V	
	AC/DC24V	AC/DC36V	AC/DC220V	
RatedCurrent	About15mA		About3mA	
Dropping Way	Innerresistance	Outerresistance when using6Vlamp		



Using AC/DC led lamp. Terminals have no difference of anode and cathode.  
 Non c'è differenza di polarità ai terminali del led. Collegando una resistenza esterna si può adattare il funzionamento del led ad una tensione superiore : ad esempio il led interno è di 5V. Con una resistenza esterna da 1K il led può funzionare a 12V.

HBS1GQ19 SERIES mounting hole :  $\Phi$  19



HBS1GQ19 SERIES mounting hole :  $\Phi$  19

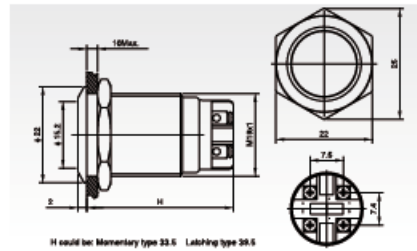
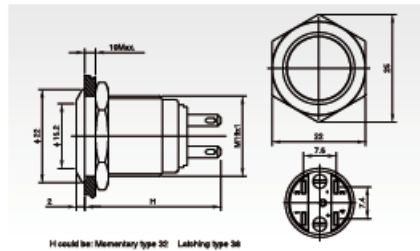

■ = contatti

■	HBS1GQ-11S	HBS1GQ1-11LS	
Terminal Type	Pin Terminal (2.8 x 0.5 mm)	Screw Terminal	
Switch Type	Momentary or Latching		
Switch Specifications	Ith: 5A / Ui: 250VAC	Ith: 5A / Ui: 250VAC	
Contact Resistance (m $\Omega$ )	$\leq$ 50	$\leq$ 50	
Insulation Resistance (M $\Omega$ )	$\geq$ 1000	$\geq$ 1000	
Dielectric Strength (VAC)	2000	2000	
Operating Temperature	-20°C ~ +55°C	-20°C ~ +55°C	
Mechanical Life (times)	> 1.000.000	> 1.000.000	
Electrical Life (times)	> 200.000	> 200.000	
Panel Thickness (mm)	1 ~ 10	1 ~ 10	
Tonque (Nm)	5 ~ 14	5 ~ 14	
Operating Pressure (N)	about 4	about 4	
Operating Stroke (mm)	about 2.5	about 2.5	
Protection Degree	IP65 / IP67, IK09	IP65 / IP67, IK09	
Material	Contact	Silver Alloy	Silver Alloy
	Button	Stainless Steel	Stainless Steel
	Case	Stainless Steel	Stainless Steel
	Base	PC	PC



HBS1GQ19 SERIES mounting hole :  $\Phi$  19

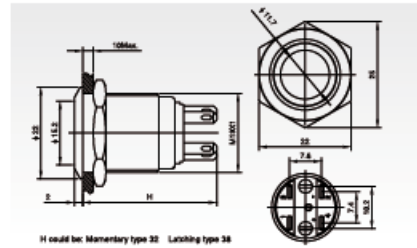
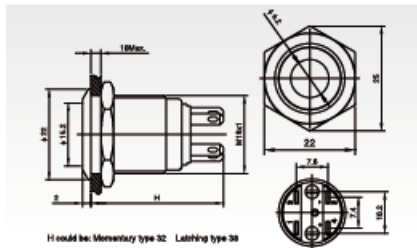

■ = contatti ▲ = colore ▲ = V Led

■ ▲ ▲		HBS1GQ-11DS	HBS1GQ1-11ES
Terminal Type		Screw Terminal	Screw Terminal
Switch Type		Momentary or Latching	
Switch Specifications		Ith: 5A / Ui: 250VAC	Ith: 5A / Ui: 250VAC
Contact Resistance (mΩ)		≤ 50	≤ 50
Insulation Resistance (MΩ)		≥ 1000	≥ 1000
Dielectric Strength (VAC)		2000	2000
Operating Temperature		-20°C ~ +55°C	-20°C ~ +55°C
Mechanical Life (times)		> 1.000.000	> 1.000.000
Electrical Life (times)		> 200.000	> 200.000
Panel Thickness (mm)		1 ~ 10	1 ~ 10
Tonque (Nm)		5 ~ 14	5 ~ 14
Operating Pressure (N)		about 4	about 4
Operating Stroke (mm)		about 2.5	about 2.5
Protection Degree		IP65 (IP67), IK09	IP65 (IP67), IK09
Material	Contact	Silver Alloy	Silver Alloy
	Button	Stainless Steel	Stainless Steel
	Case	Stainless Steel	Stainless Steel
	Base	PC	PC
Lamp Parameters	Type	Dot-illuminated LED	Ring-illuminated LED
	Rated Voltage (V)	6 / 12 / 24 / 110 / 220	6 / 12 / 24 / 110 / 220
	Color	R G Y O B W	R G Y O B W
	Life	50.000	50.000

HBS1GQ19 SERIES mounting hole :  $\Phi$  19



HBS1GQ-11DLS



HBS1GQ1-11ELS

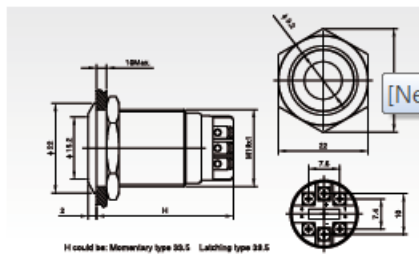

H could be: Momentary type 22.5 Latching type 22.5

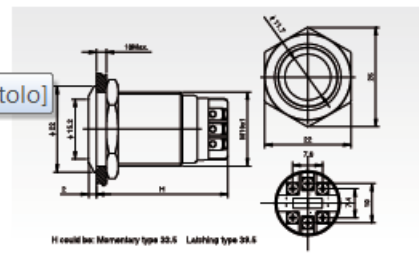

H could be: Momentary type 22.5 Latching type 22.5

■ = contatti ▲ = colore ▲ = V Led

■ ▲ ▲		HBS1GQ-11DLS	HBS1GQ1-11ELS
Terminal Type		Screw Terminal	Screw Terminal
Switch Type		Momentary or Latching	
Switch Specifications		Ith: 5A / Ui: 250VAC	Ith: 5A / Ui: 250VAC
Contact Resistance (mΩ)		≤ 50	≤ 50
Insulation Resistance (MΩ)		≥ 1000	≥ 1000
Dielectric Strength (VAC)		2000	2000
Operating Temperature		-20°C ~ +55°C	-20°C ~ +55°C
Mechanical Life (times)		> 1.000.000	> 1.000.000
Electrical Life (times)		> 200.000	> 200.000
Panel Thickness (mm)		1 ~ 10	1 ~ 10
Tonque (Nm)		5 ~ 14	5 ~ 14
Operating Pressure (N)		about 4	about 4
Operating Stroke (mm)		about 2.5	about 2.5
Protection Degree		IP65 (IP67), IK09	IP65 (IP67), IK09
Material	Contact	Silver Alloy	Silver Alloy
	Button	Stainless Steel	Stainless Steel
	Case	Stainless Steel	Stainless Steel
	Base	PC	PC
Lamp Parameters	Type	Dot-illuminated LED	Ring-illuminated LED
	Rated Voltage (V)	6 / 12 / 24 / 110 / 220	6 / 12 / 24 / 110 / 220
	Color	<b>R</b> <b>G</b> <b>Y</b> <b>O</b> <b>B</b> <b>W</b>	<b>R</b> <b>G</b> <b>Y</b> <b>O</b> <b>B</b> <b>W</b>
	Life	50.000	50.000

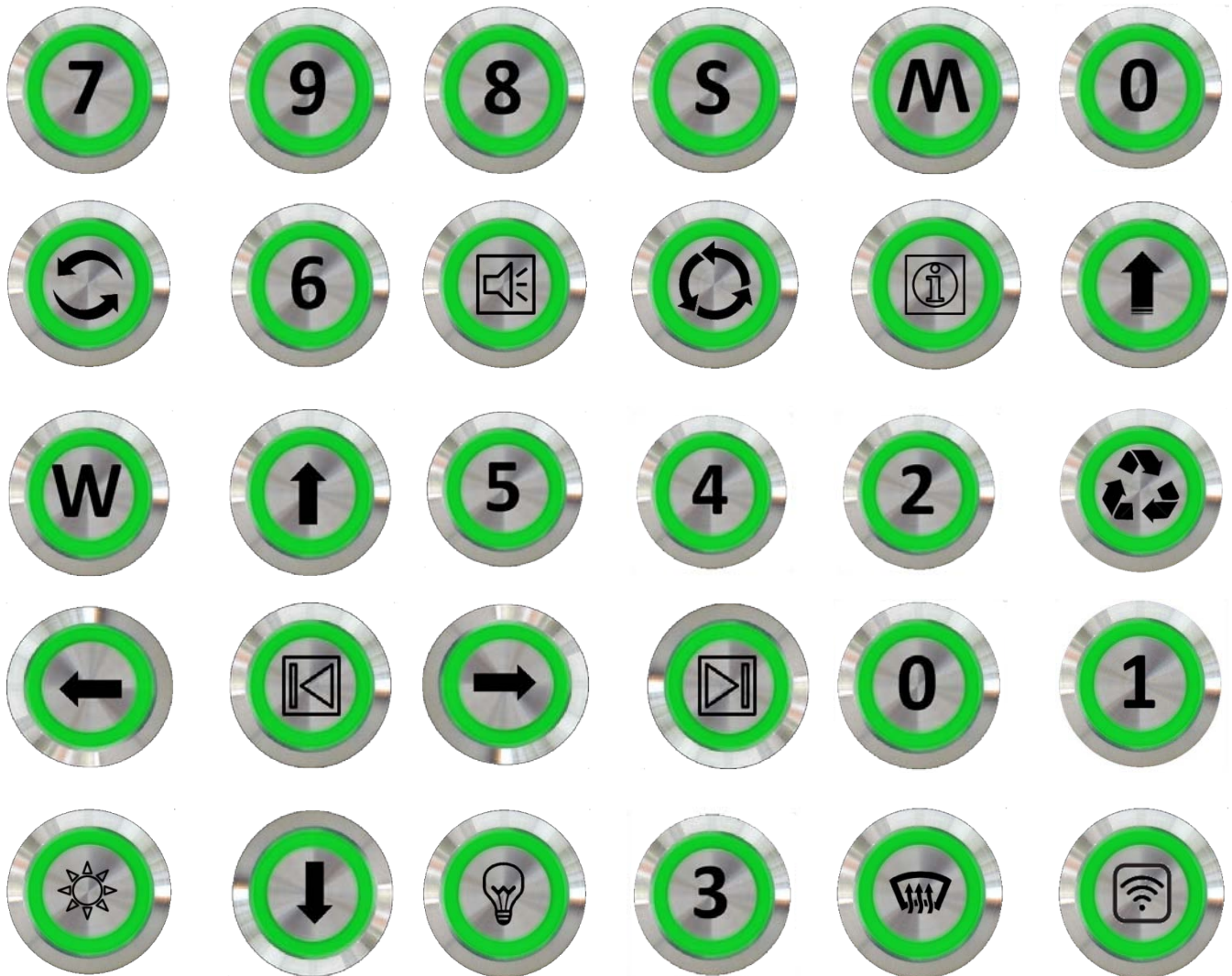

Per mezzo di stampa Laser, è possibile realizzare serigrafie grafiche ed alfanumeriche, sui tasti della serie HBGQ ed HBS1, partendo dal diametro minimo 19mm. Le lavorazioni offrono la massima personalizzazione del proprio interruttore, inviando, all'atto dell'ordine, i simboli o lettere personalizzate in formato PDF.